



User Manual



Wireless Activity Wristband



Product
Info



www.aldi.com.au

+ VIDEO

Contents

Overview	4	Sleep mode	27
Use	5	Alarm function	28
Scope of delivery/ device parts	6	Compatible Bluetooth® devices	29
QR code	7	Watertightness.....	30
General information	9	Operation	32
Reading and storing the instruction manual....	9	Charging the rechargeable battery.....	32
Explanation of symbols	10	Inserting the display module	34
Safety	13	Putting on the wristband/clip.....	35
Proper use	13	Activating the display module	36
Safety notes	14	Switching the display module off.....	36
Checking the wristband/ Product contents	18	Setting the time and time mode.....	37
Functions	19	Downloading and installing the Crane Connect app.....	37
Data storage	21	Connecting the wristband with the Crane Connect app.....	40
Modes	21	Using the wristband without the Crane Connect app.....	42
Time mode	23	Activating sleep mode.....	43
Step counter mode	24	Deactivating sleep mode	44
Distance mode	25		
Calorie mode	26		
Activity Time mode	27		

Care and maintenance	45
Cleaning the wristband.....	45
Storing the wristband.....	46
Troubleshooting	47
Declaration of conformity	49
Technical data	50
Disposal	51
Disposing of the packaging	51
Disposing of the wristband	51
Warranty	53
Warranty Certificate.....	53
Repair and Refurbished Goods or Parts Notice	55
Warranty Certificate.....	57
Customer Service	61

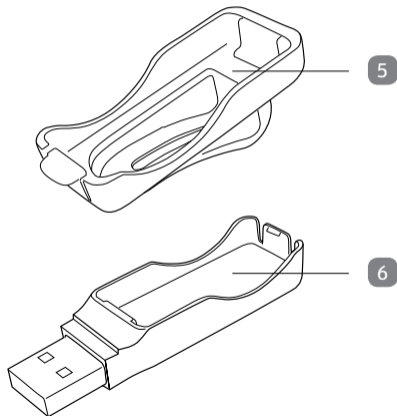
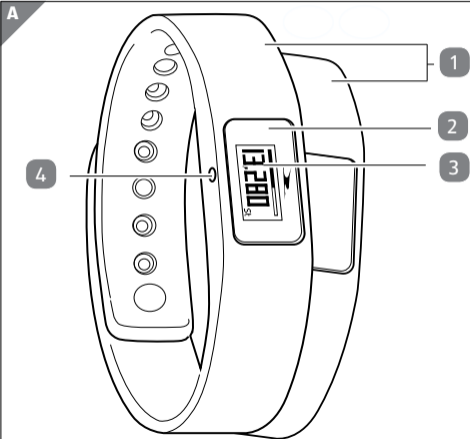

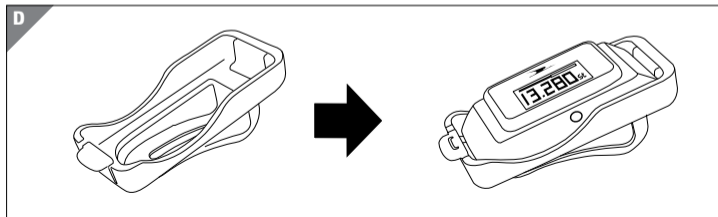
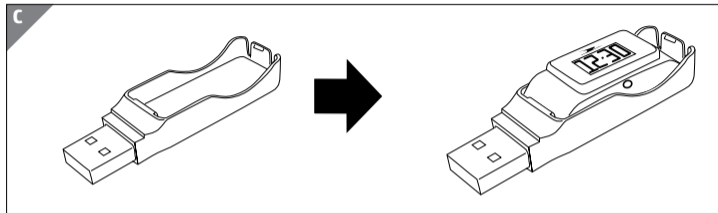
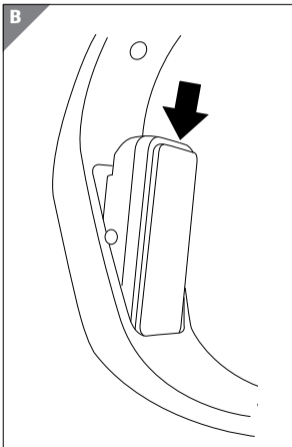

Scope of delivery/ device parts

- 1 Band, 2x
- 2 Display module, removable
- 3 Display (OLED display)
- 4 Menu button
- 5 Clip
- 6 USB charger

ALDI guarantees that our exclusive brand products are developed to our stringent quality specifications. If you are not entirely satisfied with this product, please return it to the nearest ALDI store within 60 days from the date of purchase, for a full refund or replacement, or take advantage of our after sales support by calling the supplier's Customer Service Hotline.



AUS

Made in China

Crane is a registered trademark of ALDI Stores

Distributed By:

Aldi Stores

1 Sargents Road

Minchinbury nsw 2770

www.aldi.com.au

AFTER SALES SUPPORT

W¹



1800 13 1579



service@produktservice.info

Model: AA5-CDAT-2 A /2B/2C/2D Product code: 92072

03/2015

3
YEARS
WARRANTY